

Order designation: **Manual Control Point Type 6(A) IP \_\_ colour**  
Example: **Manual Control Point Type 6(A) IP 43 orange**

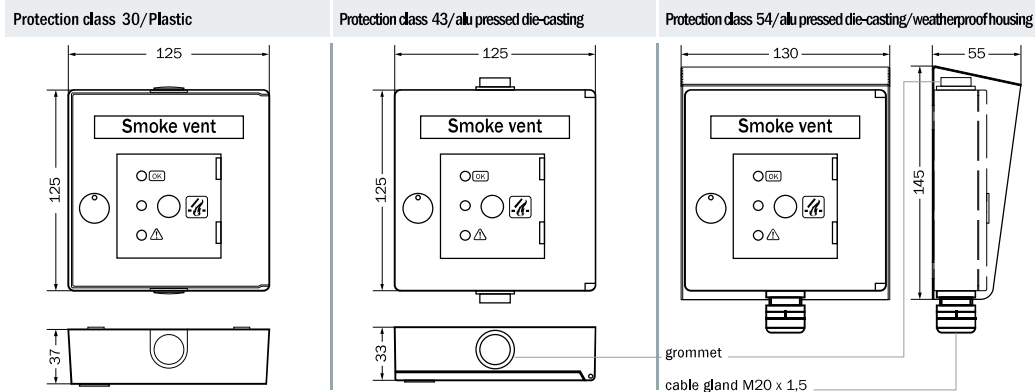

Fixation options on the back side of housing

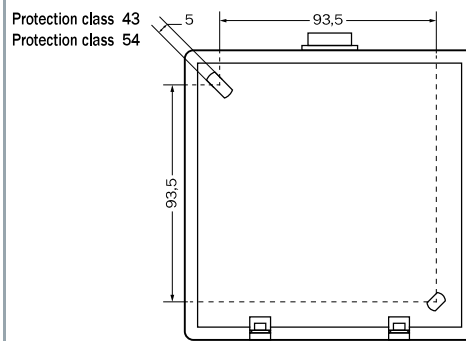
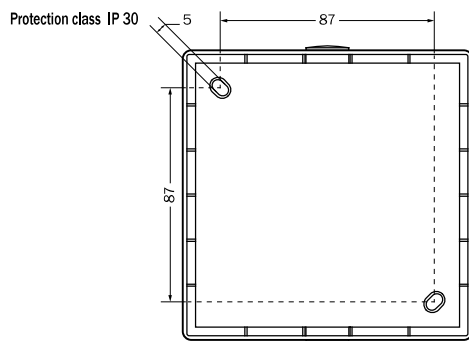

operating display	trigger display	fault display	"Close" button	trigger button	mass	reset button
1	2	3	4	5	6	7

Connection allocation smoke and heat ventilation button 6

operating display	trigger display	fault display	"Close" button	trigger button	masse	reset button	buzzer
1	2	3	4	5	6	7	8

Connection allocation smoke and heat ventilation button 6(A)

The smoke and heat ventilation button 6(A) is used for the smoke and heat ventilation control unit and has the following functions:

1. Triggering of the smoke and heat ventilation function.
2. Reset of the smoke and heat ventilation control unit group. The top right button is pressed.
3. Closure of the smoke and heat ventilation control unit group. If pressed once, the smoke and heat ventilation control unit group runs autonomously into the "Close"-direction (button right down).
4. Visual signaling via a green operating indicator.
5. Visual signaling via a red operating trigger indicator.
6. Visual signaling via a yellow fault indicator.
7. Option A: with acoustic signal

Several smoke and heat ventilation buttons 6(A)/7(A) can be connected to a line. Here to a 33 Ω terminal resistance is connected to the last smoke and heat ventilation button of the line (or single) via the terminals 11 and 13. The complete connection is performed according to the special circuit diagram!

Type	Smoke and heat ventilation button 6(A) colour
housing colour	orange, RAL 2011 (deep orange) red, RAL 3000 (fire red) blue, RAL 5009 (azure blue) grey, RAL 7035 (light grey) yellow, RAL 1018 (zinc yellow)
LED operating values	24 V <sup>+50 %/-30 %</sup> / 2 mA DC
switching capacity of all buttons	24 V <sup>+50 %/-30 %</sup> / 20 mA DC
screw terminals	max. 1,5 mm <sup>2</sup>
temperature range	fire protected up to 90 °C
environmental class	according to VdS 2592 environmental class I (-5 °C to +55 °C)

For the expansion of the protection class IP 43 and IP 54, a weatherproof hood is required.

weatherproof housing	RAL 7035 (light grey)
----------------------	-----------------------

replacement disc	80 x 80 x 0,9	flush frames	only for IP 30
replacement key		weatherproof housing	only for IP 54

## Short description

## Technical data

## Accessories