

**PRIMAT-E** kompakt **A 230 V AC**  
**PRIMAT-S** kompakt **A 24 V DC**

**Profilschnitte**  
**Profil section**

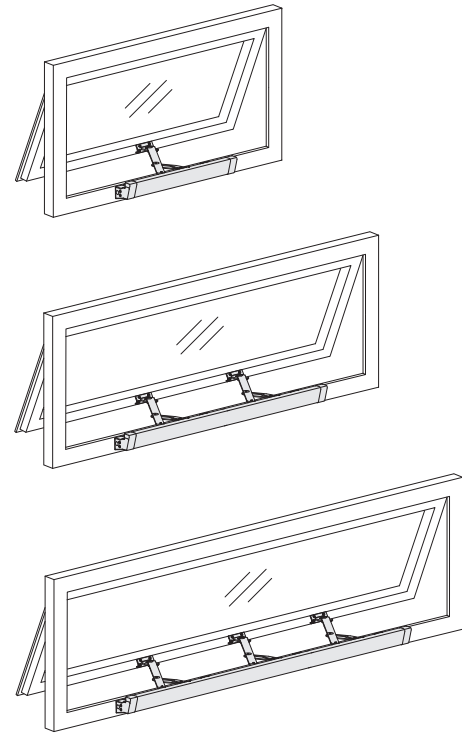

**Holz**  
 wood

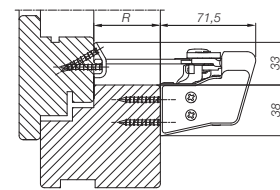

**Aluminium**  
 aluminium

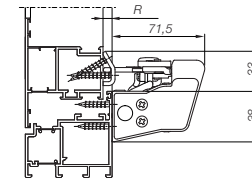

**Kunststoff**  
 plastic

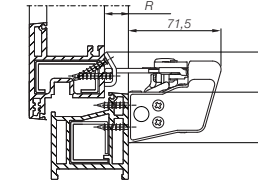

R [mm]	Flügelbock sash bracket
0-25	R 0-25
26-50	R 26-50
51-75	R 51-75
76-100	R 76-100

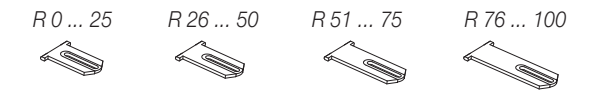

**Anwendungsbereiche**  
**Application areas**

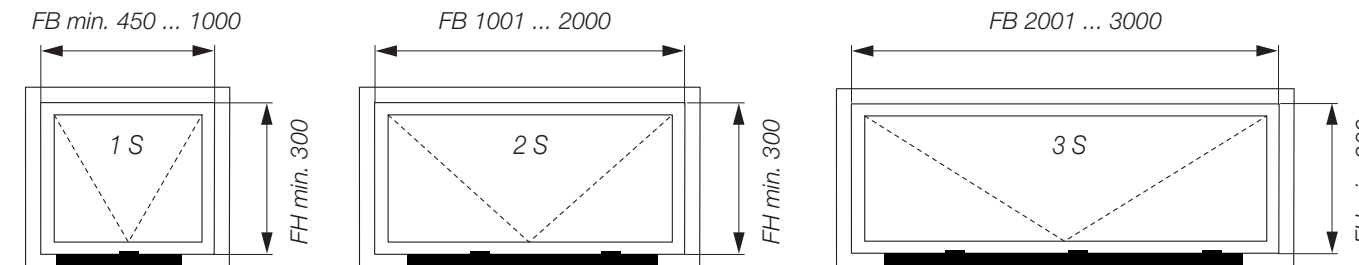

**max. Flügelgewicht 80 kg**  
 max. sash weight

**max. Glasgewicht 30 kg/m²**  
 max. glas weight

Alle Anwendungsdiagramme gelten nur unter nachfolgenden Bedingungen  
 All application charts are subject to the following conditions

Keine Zusatzlasten an den Flügel anbringen  
 No additional encumbrances

Keine Windlasten  
 No wind load

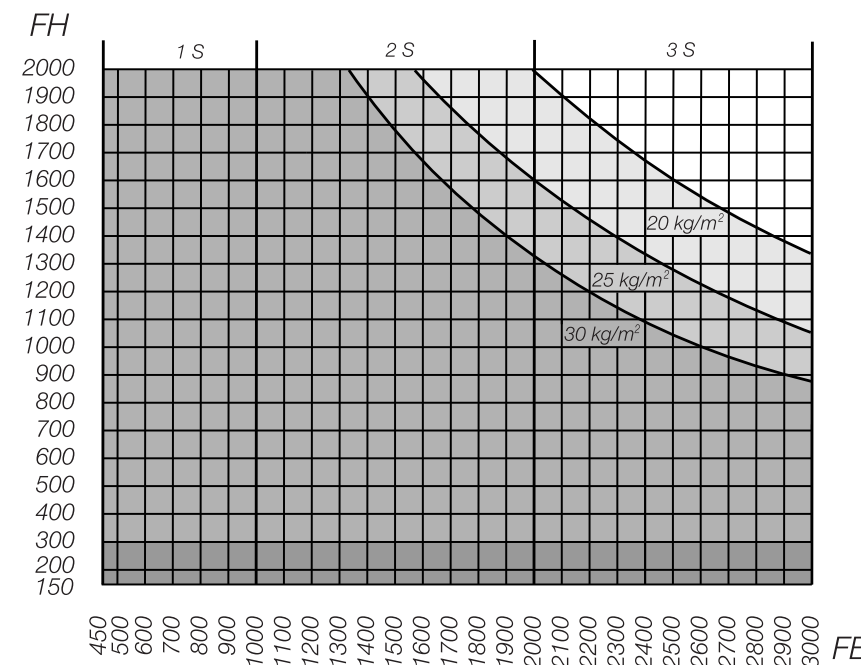

Bei Flügelhöhen unter 300 mm, muss die Öffnungsweite reduziert werden (< 190 mm).  
 If the sash height is smallest than 300 mm, the opening width must be reduced (< 190 mm).

Alle Maße in [mm]  
 All units in millimeters [mm]