

Order designation: PKA 40 - stroke
Example: PKA 40 - 600

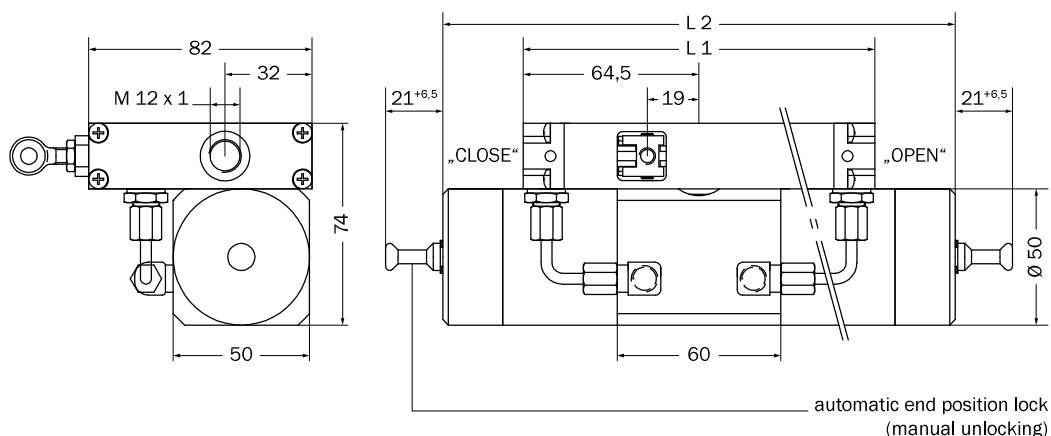

Mounting on tilt-wing

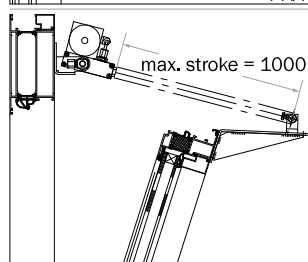
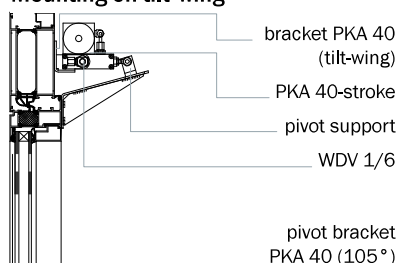

Mounting on swing-wing

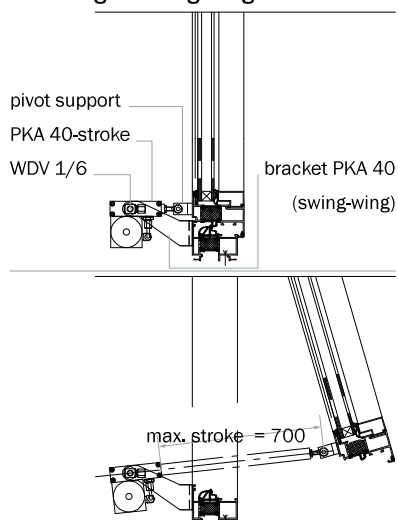

The pneumatic chain drive PKA 40 is fit both for the opening of the tilt-wings and swing-wings. It distinguishes itself by its level position before the frame while it does not protrude into the room.

By the pressurization of a "cylinder side" with simultaneous pressure release of the other "cylinder side" a shear/tensile force is performed. Once the piston has reached its end position the locking of the piston rod is performed. Manual unlocking is performed by pulling at the unlocking piston.

Short description

For the installation of the PKA 40 on the tilt-swing it should be considered that the same should be provided with an additional safety catch.

Installation

Technical data

connections	M 12 x 1
holding force of lockings	3000 N
stroke a) with pressure load	a) max. 700 mm
b) with tensile load	b) max. 1000 mm
piston diameter	40 mm
max. dyn. operating pressure	28 bar
max. stat. operating pressure	60 bar
pressure medium	a) filtered, dry and unoled compressed air according to DIN ISO 8573-1 b) CO ₂
minimum actuation pressure	2 bar
shear and tensile force with 6 bar	min. 250 N
temperature range	-20 °C to +110 °C
maintenance	related to visual control (dirty chain, lockings, etc.)
materials	aluminum, niro, steel, brass, Perbunan

stroke	L1	L2
300	232,5	559
400	300,0	659
500	300,0	757
600	368,0	857
700	368,0	955
800	469,5	1055
900	469,5	1153
1000	469,5	1253